

ORTANA  
CORNER UNIT

CUTBACK AT 90 DEGREE  
ANGLE FROM THE  
GUILTINE SPLIT

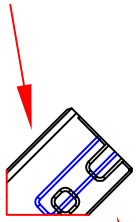

200mm WHEN COURSE IS  
VERTICAL WITH PREVIOUS,  
190mm WHEN COURSE IS  
SETBACK FROM PREVIOUS

GUILTINE SPLIT AT 45 DEGREES,  
LENGTH 100mm FOR A VERTICAL  
WALL, 90mm FOR A SETBACK WALL

EVEN  
COURSE

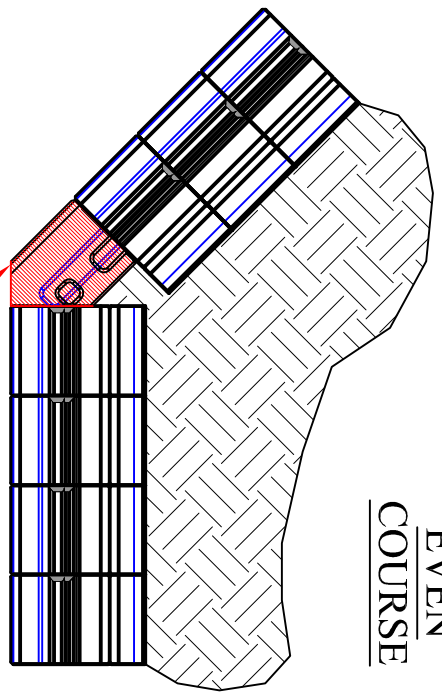

ODD  
COURSE

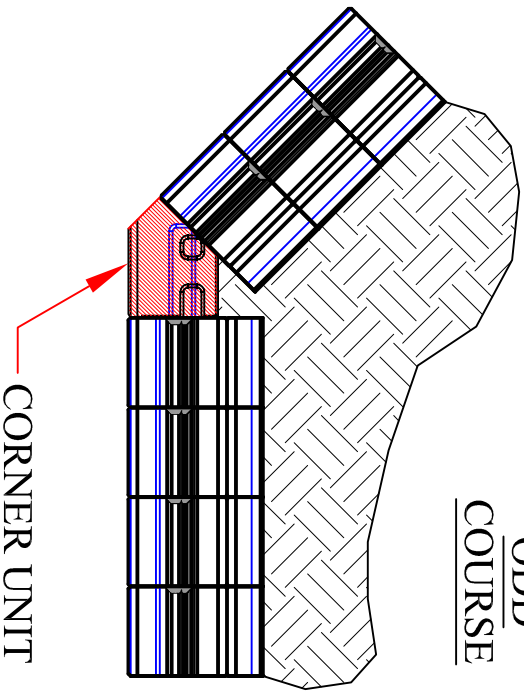

This graphic represents a preliminary, non site-specific design. If used for construction, a registered professional engineer must be retained to review & approve the design, confirm site conditions, and inspect construction.

Ortana Retaining Wall System  
45-Degree Outside Corner Details

