

- NOTES:
1. GUARD TO BE DESIGN BY OTHERS IN ACCORDANCE WITH APPLICABLE ONTARIO BUILDING CODE (OBC) REGULATIONS AND CSA STANDARDS. MAXIMUM GUARD HEIGHT 1,220mm (4'), MAXIMUM SPACING BETWEEN MOUNTING PLATES 1,296mm (4'-3").
  2. GLUE FOUR UPPER COURSES OF ORTANA WALL BLOCKS TOGETHER DURING INSTALLATION, AND INCLUDE MINIMUM ONE LAYER OF GEOMEMBRANE REINFORCEMENT AS SHOWN - THIS IS FUNDAMENTAL TO ACHIEVE COMPLIANCE TO SECTION 9.8.8.2 OF OBC. CONTRACTOR TO ENSURE UNITS ARE STAGGERED BETWEEN COURSES, AND ADHERED TOGETHER THROUGHOUT USING TWO CONTINUOUS BEADS (FRONT AND BACK) OF EXTERIOR HEAVY DUTY ADHESIVE (SEK SUREBOND SB-10 OR EQUIVALENT). ADHERE STRICTLY TO ADHESIVE MANUFACTURERS' INSTRUCTIONS TO ACHIEVE FULL ADHESIVE BOND STRENGTH.
  3. PLACE COPING UNITS (DO NOT ADHERE AT THIS POINT) AND MARK BOLTHOLE LOCATIONS. RECOMMEND BOLTHOLES BE LOCATED A MINIMUM OF 62.5mm (2.5") FROM ALL OUTSIDE EDGES OF COPING UNITS. ADJUST LOCATION OF COPING, AND CUT COPING UNITS AS REQUIRED, TO MEET SPACING REQUIREMENTS.
  4. MARK LOCATION OF HOLES IN BASE PLATE ONTO COPING, AND DRILL FOUR HOLES THROUGH COPING AND TOP THREE COURSES OF WALL BLOCK. ONCE DONE, ADHERE COPING TO WALL BLOCKS (ENSURE HOLES LINE UP).
  5. INSERT 10M (3/8") H.D. GALVANIZED THREADED RODS INTO EACH DRILL HOLE AND EPOXY INTO PLACE. FASTEN BASE PLATE USING GALVANIZED NUTS. TRIM EXPOSED PORTIONS OF RODS AS REQUIRED.

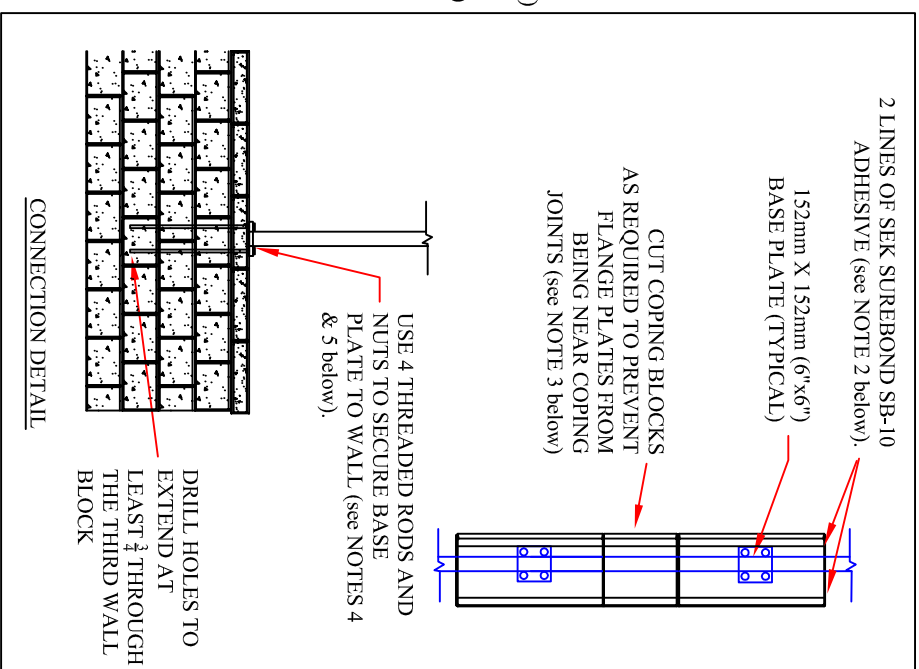

This graphic represents a preliminary, non site-specific design. If used for construction, a registered professional engineer must be retained to review & approve the design, confirm site conditions, and inspect construction.

## Ortana Retaining Wall System Pedestrian Guard Surface Mounted